

SSC Electronic Valve Actuator

24 Vac, Floating Control
Spring Return or Non-Spring Return



SSC81U Electronic Valve Actuator.

Description

The Powermite SSC81U and SSC81.5U Electronic Valve Actuators require a 24 Vac supply and receive a floating control signal. These actuators control Powermite MT Series Valves with a 7/32-inch (5.5 mm) stroke.

Features

- UL listed for plenum installations
- Direct coupled, one step installation without special tools
- Close off up to 120 psi
- Manual override
- Visual position indication
- Spring return or non-spring return
- Orderable as an actuator only or as a complete valve/actuator assembly

Applications

The Powermite SSC81... Electronic Actuators and MT Series Valves are used in heating and cooling applications in liquid and steam applications requiring a minimum of 67 lbs. (300 N) nominal force. The SSC81... accepts plenum cable or 3/8-inch flex conduit connection.

A-147

Valves

SSC81 Actuator Specifications

Operating Voltage 24 Vac \pm 20%
Frequency 50/60 Hz \pm 2 Hz
Power Supply Earth Ground Isolating, Class 2, 24 Vac Transformer
Power Consumption
 SSC81U 0.8 VA
 SSC81.5U 2 VA
Control Signal
 Y2 24 Vac Retracts Actuator Shaft
 Y1 24 Vac Extends Actuator Shaft
Running Time
 SSC81U 125 sec. \pm 2% at 60 Hz
 SSC81.5U 125 sec. \pm 2% at 50/60 Hz
 Spring Return (SSC81.5U only) ~30 sec.

Nominal Stroke 7/32-inch (5.5 mm)
Nominal Force 67 lbs. (300N)
Spring Return (SSC81.5U only) Non-mechanical, Electronic Return Fails to Stem up (0 Position)
Agency Approvals UL/cUL, UL873 Listed, Certified to Canadian Standard C22.2 No. 24-93
Ambient Temperature
 Operation 41 to 122°F (5 to 50°C)
 Transport and Storage -13 to 158°F (-25 to 70°C)
Ambient Humidity 0 to 90% RH, Non-condensing
Wiring Connection Plenum Cable or 3/8-inch Flex Conduit
Mounting Location NEMA 1 (Interior Only)

SSC81 Actuator Product Ordering

Description	Part No.	Actuator Prefix Code
Spring Return	SSC81.5U	260
Non-Spring Return	SSC81U	259

A-148

Valves

Dimensions

Valve Size in.	Center Line to Top of Actuator		Service Height		Actual Width of Actuator	Service Width
	H ¹		H		W ¹	W
	NO	NC	NO	NC		
1/2" (15 mm)	5-1/2" (140 mm)		13-1/2" (343 mm)		5-1/2" (140 mm)	13-1/2" (343 mm)
3/4" (20 mm)	5-1/2" (140 mm)		13-1/2" (343 mm)		5-1/2" (140 mm)	13-1/2" (343 mm)
1" (25 mm)	5-3/4" (146 mm)		13-3/4" (349 mm)		5-1/2" (140 mm)	13-1/2" (343 mm)

Service height and width are the recommended dimensions to allow access to the product.

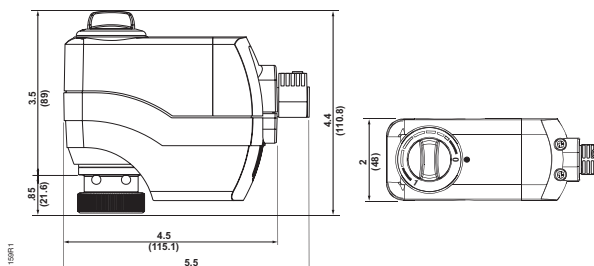
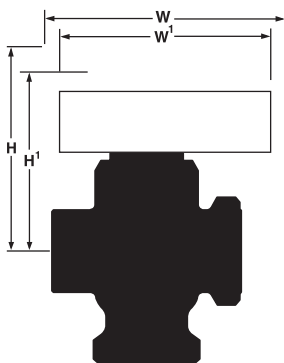

Dimensions shown in inches (mm).